



**Community Meeting on
Proposed Project in
City of Burlingame, CA**

April 10, 2019



- Currently 53 venues (49 US venues, 4 international venues)
 - Roseville, CA opened in 2016
- 10 venues scheduled to open in 2019
 - San Jose scheduled to break ground in Q2 2019



- Proposed Burlingame, CA Facility
 - 3 story building
 - 71,024 square feet
 - 53' maximum building height (approx.)
 - 3 main full service bars with seating areas
 - Food and alcohol served by wait staff throughout the entire venue

Proposed Building Layout (2nd Floor)

Level Two - Occupancy Calculations			
Room Name	Area (sq. ft.)	Factor	Load
Lobby (standing only)	386	5 net sf	78
Event (Table & Chairs)	1,751	15 net sf	117
Concessions / Back of Bar	445	200 gross sf	3
Scullery/Kitchen	2,822	200 gross sf	15
Storage	553	300 gross sf	2
Mechanical	189	300 gross sf	1
Game Area	692	11 gross sf	63
Hitting Bays	4,000	12 gross sf	267
Exterior Patio	821	15 gross sf	55
Level Two Total Occupancy :			601

Level Two Building Area (Square Feet)	22,500
Total Building Area (Square Feet)	71,024

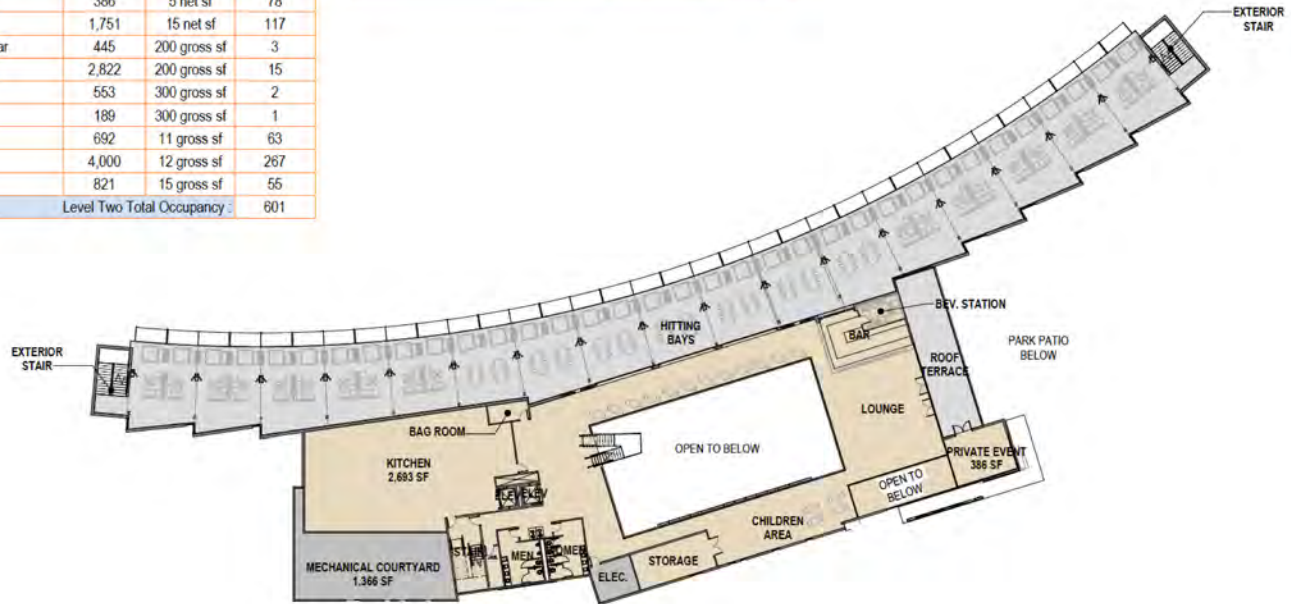

1 FLOOR PLAN- LEVEL 2
SCALE: 1/32" = 1'-0"



Proposed Building



Proposed Building (Main Entrance Zoom)



Proposed Driving Range (Day)



Proposed Driving Range (Night)



Proposed Driving Range Back (Day)



Proposed Driving Range Bay (Day View 1)



Proposed Driving Range Bay (Day View 2)



Proposed Driving Range Bay (Night)





Thank You/Questions